

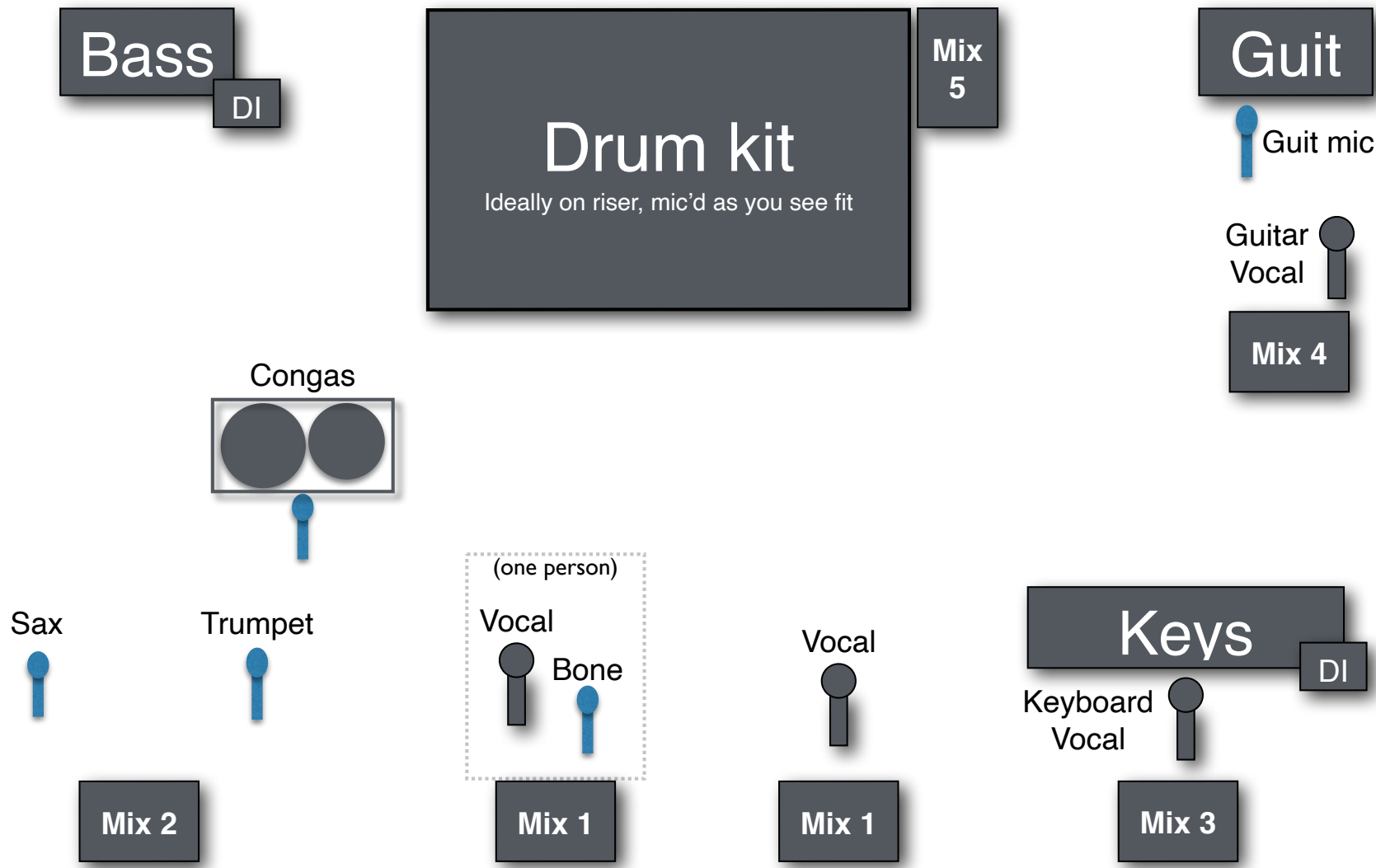

Philadelphia Funk Authority - Stage Plot

*Please help us maintain a relatively low stage volume

610-417-4278 cell
www.phillyfunk.com





Philadelphia Funk Authority - Stage Details

*Please help us maintain a relatively low stage volume

610-417-4278 cell
www.phillyfunk.com

INPUT LIST

- Kick
- Snare
- Rack Mic drums as you see fit
- Floor
- Overheads

- Bass - DI
- Keys - DI
- Guitar - mic

- Front Vocal 1
- Front Vocal 2) wireless if available
- Guitar Vocal
- Keyboard Vocal

- Sax the horns like to use
- Trumpet our own clip-on mics if
- Trombone you don't object; may or
may not be wireless

- Congas band carries Audio D2
with rim mount

MONITORS

MIX 1:

All vocals + keys
NO HORNS

MIX 2:

All horns + keys
NO VOCALS

MIX 3:

keyboard vocal + keys

MIX 4:

guitar vocal + guitar

MIX 5:

a little of everything for
drummer

Note: Our lead vocal changes frequently, even mid-song, so please try to keep all vocal channels open throughout.